

DO NOT SCALE

NOTES:

1. THIS DRAWING SHOULD BE PRINTED IN COLOUR.
2. ALL DIMENSIONS ARE IN METRES UNLESS OTHERWISE STATED.
3. THIS DRAWING SHOULD BE READ IN CONJUNCTION WITH ALL OTHER RELEVANT ENGINEERING DRAWINGS.
4. THE PROPOSED LAYOUT SHOWN IS SUBJECT TO PLANNING APPROVAL AND DETAILED DESIGN.
5. THIS IS A PRELIMINARY DESIGN DRAWING. DO NOT UNDERTAKE ANY WORK BASED ON THE INFORMATION PROVIDED ON THIS DRAWING

KEY:

- PROPOSED KERBLINE
- PROPOSED EDGE OF FOOTWAY / CYCLEWAY
- WINNERSH RELIEF ROAD PHASE 1 PROPOSED KERB LINES TO REMAIN
- - - PROPOSED ROUNDABOUT ENTRY VISIBILITY
- - - PROPOSED ROUNDABOUT EXIT VISIBILITY
- - - PROPOSED FENCE (POSITION INDICATIVE)
- WINNERSH RELIEF ROAD PHASE 1 PROPOSED TACTILE PAVING TO REMAIN
- PROPOSED TACTILE PAVING
- PROPOSED SHARED SPACE / CROSSING DELINEATION
- PROPOSED FOOTWAY / CYCLEWAY RESURFACING
- PROPOSED FOOTWAY / CYCLEWAY FULL DEPTH CONSTRUCTION
- PROPOSED CARRIAGEWAY RESURFACING
- PROPOSED CARRIAGEWAY FULL DEPTH CONSTRUCTION
- PROPOSED TRAFFIC ISLAND
- PROPOSED LANDSCAPED AREA
- PROPOSED BOLLARD (WITH REFLECTIVE BAND)
- ||| PROPOSED ROAD MARKINGS

30 LAYOUT SUBJECT TO A 30MPH SPEED LIMIT. EXACT EXTENTS TO BE AGREED DURING DETAILED DESIGN

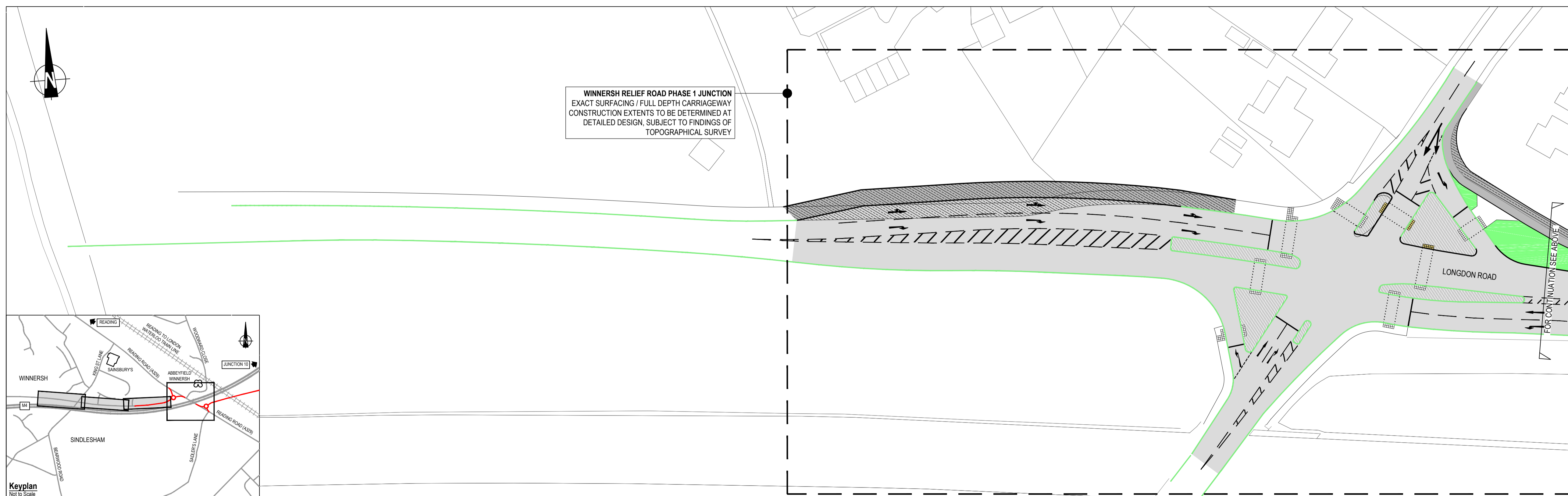
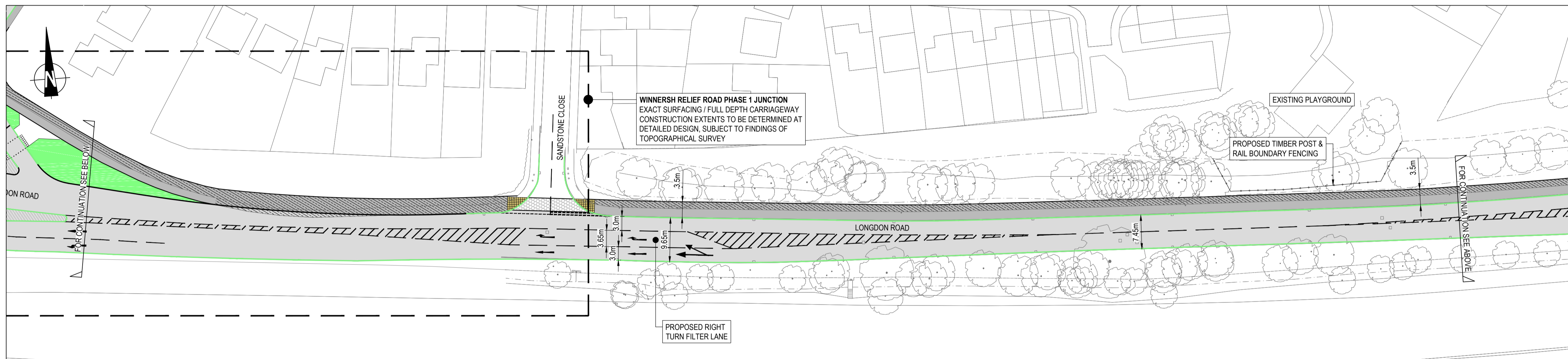
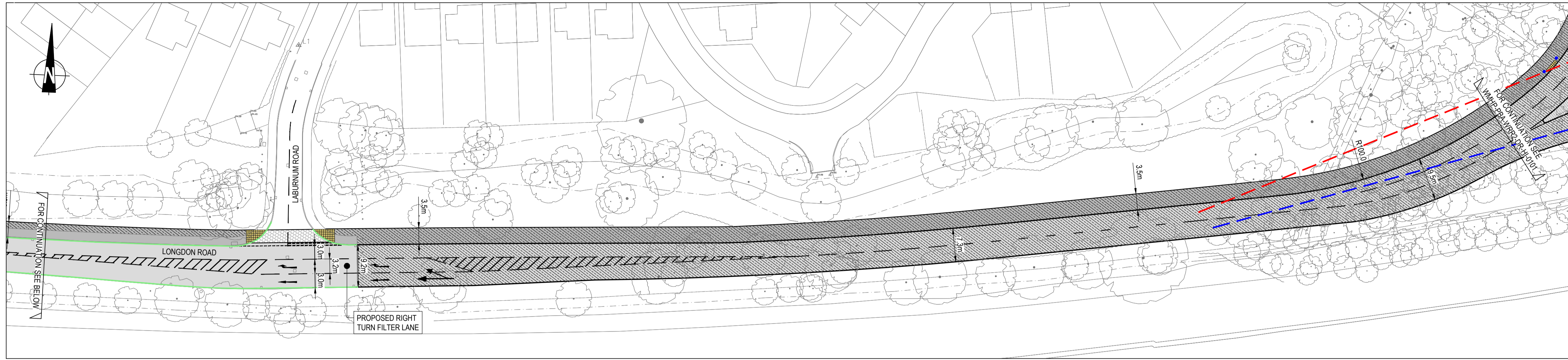

DRAWING STATUS:		S2 - SUITABLE FOR INFORMATION	
DESIGNER:			
CONTRACTOR:			
CLIENT:	<p>Shute End, Wokingham, Berkshire RG40 1BN Tel: (0118) 974 6000 Web: www.wokingham.gov.uk</p>		
PROJECT:	<p>WOKINGHAM MAJOR HIGHWAYS PROGRAMME WINNERSH RELIEF ROAD PHASE 2</p>		
TITLE:	<p>GENERAL ARRANGEMENT PLAN (SHEET 2 OF 2)</p>		
SCALE @ A1:	CHECKED:	APPROVED:	
1:500	LEE CUDDINGTON	SIMON EARL	
PROJECT NO:	DESIGNED:	DRAWN:	DATE:
39265-2011	RT	RT	August 18
DRAWING NO:	REV:		
WMHP-PBA-WRR2-DR-HI-0102			P02

This page is intentionally left blank